

## Flange Spreader



**Capacity: 15 tons**

**Access gap: 6 mm.**

**Maximum Operating Pressure:  
700 bar (10,000 psi)**

### ■ Features:

- Integrated wedge concept: friction-free, smooth, parallel wedge movement eliminates flange damage and spreading arm failure.
- Unique interlocking wedge design: no first step bending and risk of slipping out of joint.
- Requires very small access gap of only 6 mm (.24 in).
- Few moving parts means durability and low maintenance.
- Operated by any hydraulic pump with rated oil pressure of 700 bar (10,000 psi).
- Subsea work, black surface treatment anti-corrosion

### ■ Accessories:

- Safety Block
- Stepped Block

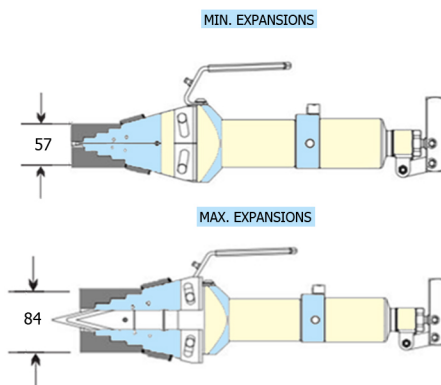
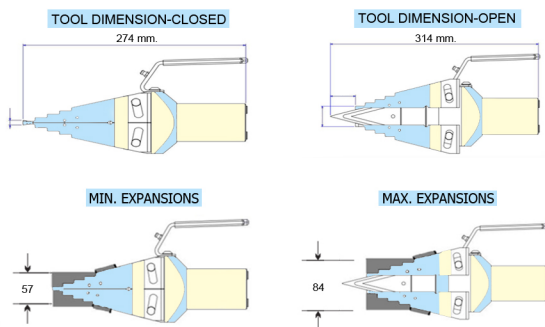
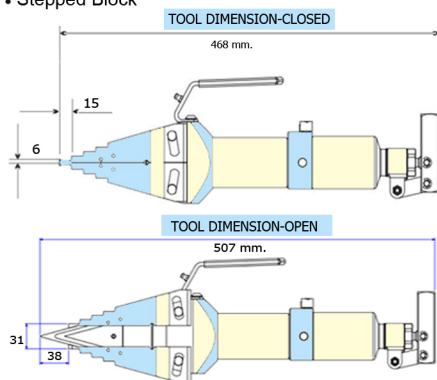

### ■ Spreader Capacity:

Model No.	Capacity	Pump Type	Spreading Distance	Max. Spread no stepped block	Max. Spread using stepped block	Weight
<b>SH 15T</b>	155KN (15.5T)	External	6 - 81 mm.	6 - 62 mm.	31 - 81 mm.	7.0 kg
<b>SH 15TC</b>	145KN (14.5T)	Integral	6 - 81 mm.	6 - 62 mm.	31 - 81 mm.	9.0 kg



"innovation in its most functional form"

## PRODUCT DATA SHEET

# SWi12/14TM

## MECHANICAL FLANGE SPREADER

### SPREADING FORCE:

12T (120kN) 1st step

14T (140kN) 4th step

### SPREADING DISTANCE:

6.0 - 103.5mm (0.24 - 4.0")

WEIGHT: 6.2kg (13.7lb)

### CAPABILITIES

With 175Nm (130ft.lb) torque applied:

12T spread force (1st step)

14T spread force (4th step)

6.0mm – 87.5mm  
(0.24" - 3.4") spread over 4 steps  
(without stepped blocks)

48.5mm – 103.5mm  
(1.9" - 4.1") spread over 2 steps  
(with stepped blocks)

6.0mm – 40.0mm  
(0.24" - 1.6") spread  
using only 1st step



### TOOL DIMENSIONS - CLOSED

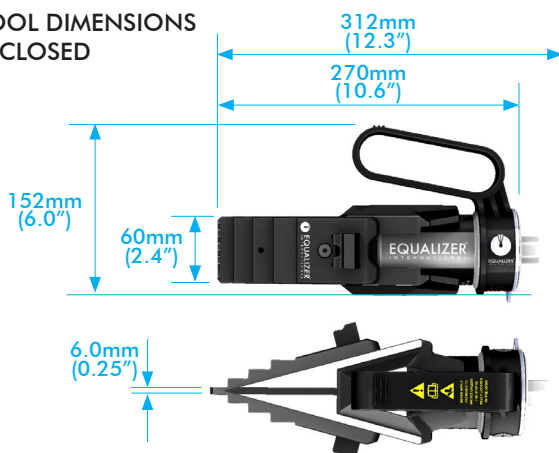

### USER FEATURES

- Practical, portable and lightweight
- Moulded plastic handle for comfort
- Revolving handle to aid horizontal or vertical spreading
- Offset handle is directly over the centre of mass
- Removable handle for improved access
- Revolving lanyard connection point
- Spread indicator markings for clear precise visual progress feedback

### SAFETY FEATURES

- No finger pinch-points
- Increased step depth on upper steps
- Safety lanyard – 1.0m (39") length
- Forged key components for strength and reliability
- Fail-safe design – designated cylinder nose seal failure

### MAINTENANCE FEATURES

- Rapid disassembly and assembly
- Quick jaw replacement – remove 1 fastener
- Quick tip replacement – remove 2 fasteners
- Narrow jaw teeth – improved tool wear

info@equalizerinternational.com  
www.equalizerinternational.com

# SWi12/14TM

## MECHANICAL FLANGE SPREADER



"innovation in its most functional form"

### JAW DIMENSIONS (WITHOUT STEPPED BLOCKS ATTACHED)

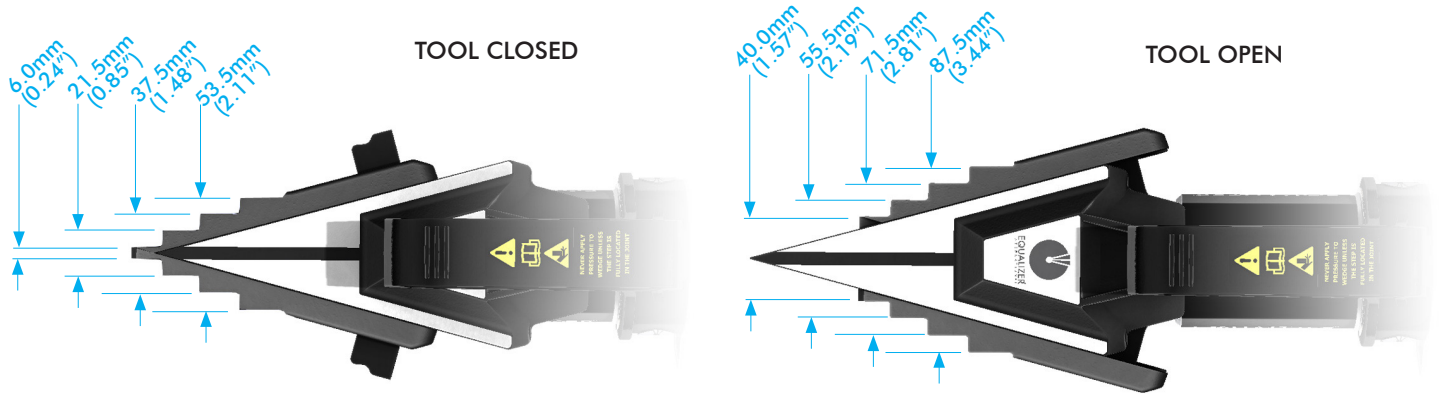

### JAW DIMENSIONS (WITH STEPPED BLOCKS ATTACHED)

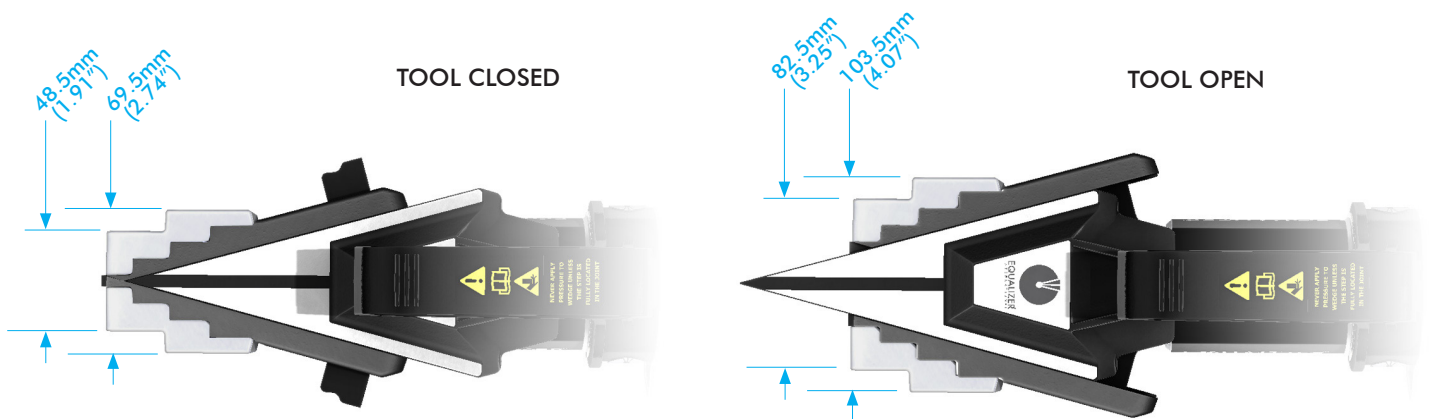

### STANDARD KIT

- 1 x SWi12/14TM Mechanical Flange Spreader Wedgehead
- 1 x 12/14TM Mechanical Cylinder
- 1 x 150ft.lb (230N.m) Torque Wrench with 22mm Socket
- 1 x Set of Safety Blocks
- 1 x Pair of Stepped Blocks
- 1 x Lanyard
- 1 x Hex Key
- 1 x Instruction Manual
- 1 x Plastic Carry Case

580mm x 330mm x 165mm (22.8" x 13.0" x 6.5")  
Gross Kit Weight 13.0kg (28.6lb)  
Product Code: SWi1214TMSTDSPB





"innovation in its most functional form"

## PRODUCT DATA SHEET

# SW14.5TI

## INTEGRAL HYDRAULIC FLANGE SPREADER

### SPREADING FORCE:

10,000 psi (700 bar) = 14.5 T (145 kN)

It is recommended that tools are used in pairs giving  
 $2 \times 14.5 = 29 \text{ T (290 kN)}$

TOOL WEIGHT = 9 kg (19.8 lbs)

### KIT COMPONENTS

- 1 x SW14.5TI Wedgehead
  - 1 x 10,000 psi (700 bar) Integral Hydraulic Pump/Cylinder
  - 1 x Safety Block
  - 1 x Pair of Stepped Blocks
  - 1 x Carry-Strap
  - 1 x Instruction Manual
  - 1 x Carry Case
- Product Code: SW14.5TISPB



### WEIGHTS AND DIMENSIONS

Wedge with Integral Hydraulic Pump Cylinder	= 9 kg (19.8 lbs)
Carry Case	= 2.5 kg (5.5 lbs)
Gross Weight	= 14 kg (28.6 lbs)

Carry-Case Dimensions:  
 580 x 340 x 180mm (22.8" x 13.4" x 7")

TOOL DIMENSIONS - CLOSED



TOOL DIMENSIONS - OPEN

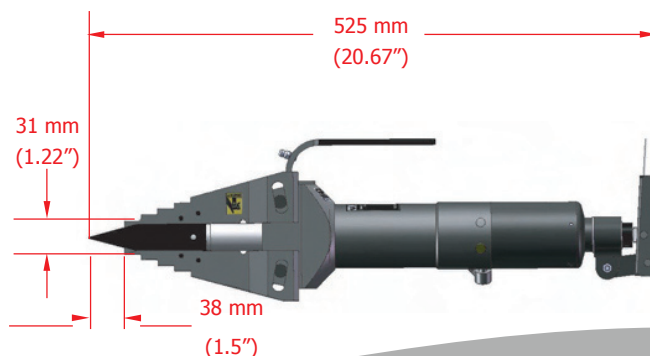

info@equalizerinternational.com  
 www.equalizerinternational.com



# SW14.5TI

INTEGRAL HYDRAULIC FLANGE SPREADER



"innovation in its most functional form"



TOOL DIMENSIONS - CLOSED



TOOL DIMENSIONS - OPEN

## SAFETY BLOCK DIMENSIONS

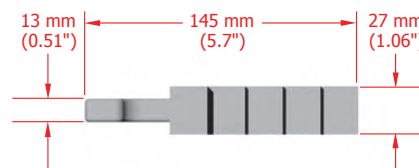
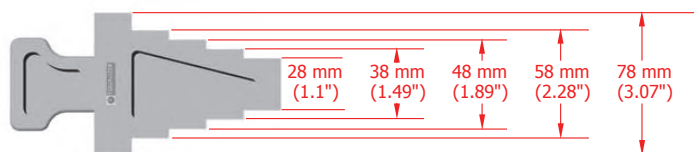

## PARTS LIST AND EXPLODED DRAWING

ITEM	PART No.	DESCRIPTION	QUANTITY
01		SERIAL NO STICKER	01 each
02		QC SEALED STICKER	02 each
03		PINCH POINT STICKER	02 each
04		GREASE POINT STICKER	02 each
05		READ INSTR. STICKER	01 each
06		BADGE LOGO	02 each
07	300101-01	WEDGE	01 each
08	300301-01	PUSH PIN	01 each
09*		M5X6 SCKT SCREW	01 set of 4
10*		SLIDE PIN	01 set of 4
11	301102-01	MAIN BODY	01 each
12*		SPIROL PIN	01 set of 8
13*		M6X12 GRUB SCREW	01 each
14	308201-01	HANDLE	01 each
15	310601-01	M6 GREASE NIPPLE	01 each
16	311601-01	SPLIT RING	01 set of 2
17	312302-01	HANDLE SLEEVE	01 each
18	300203-02	FORGED JAW	01 set of 2
19*		5/16" SCREW	01 each
20	510701-01	INT. PUMP & CYLINDER	01 each
21	375010-01	SERVICE KIT A (Not illustrated)	01 kit
22	375020-01	SERVICE KIT C (Not illustrated)	01 kit
23	510700-01	SERVICE KIT D (Not illustrated)	01 kit

\*Items 09,10,12,13 and 19 are supplied in repair kit part no: 310301-01

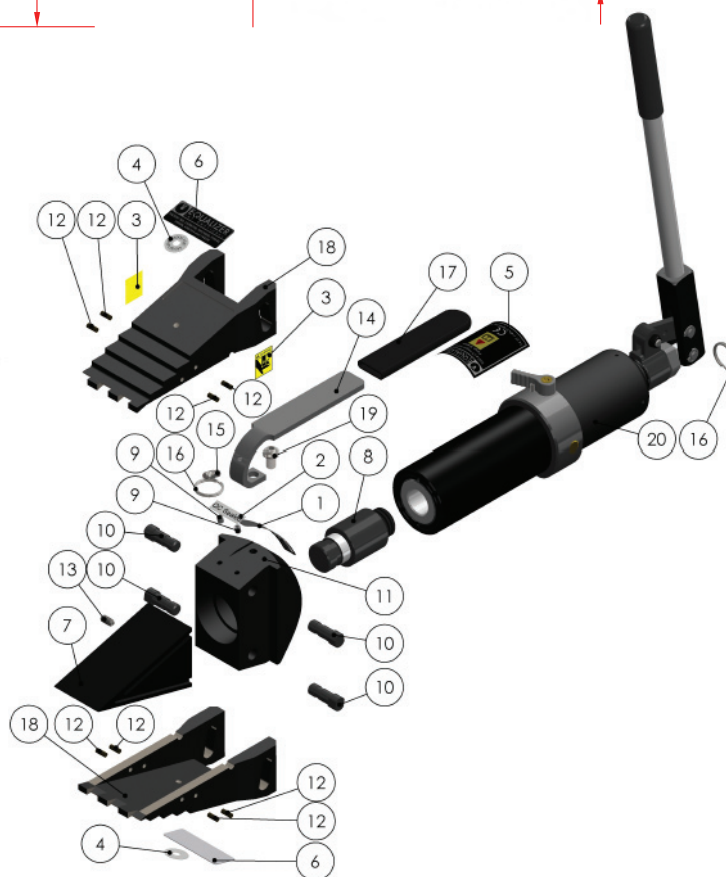

## STEPPED BLOCKS

Stepped Blocks can be used singly or in pairs to increase the maximum spreading distance of the SW9TM to 81mm

## STEPPED BLOCK KIT (AVAILABLE AS AN OPTION)

### KIT COMPONENTS

2 x Stepped Blocks  
2 x M6 x 10 mm Countersunk Screws  
1 x 4mm Hex Key  
Kit Part No: 303301-01

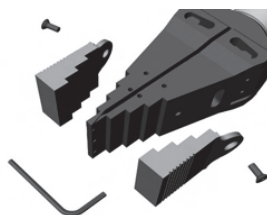

## WEIGHTS AND DIMENSIONS

Stepped Block = 0.52 kg (1.14 lb)

GROSS WEIGHT = 1.5 kg (3.5 lb)

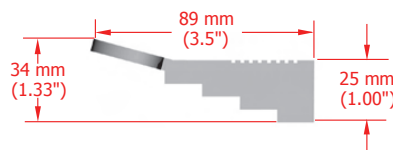



FLANGE TOOL INNOVATION

## PRODUCT DATA SHEET



# SWi20/25TE

## HYDRAULIC FLANGE SPREADER

### SPREADING FORCE:

20T (200kN) 1st step

25T (240kN) 4th step

### SPREADING DISTANCE:

6.0 - 103.5mm (0.24 - 4.0")

WEIGHT: 6.4kg (14.02lb)

### CAPABILITIES

At 10,000psi – 700bar:

20T spread force (1st step)

24T spread force (4th step)

6.0mm – 87.5mm  
(0.24" - 3.4") spread over 4 steps  
(without stepped blocks)

48.5mm – 103.5mm  
(1.9" - 4.1") spread over 2 steps  
(with stepped blocks)

6.0mm – 40.0mm  
(0.24" - 1.6") spread  
using only 1st step



### TOOL DIMENSIONS - CLOSED

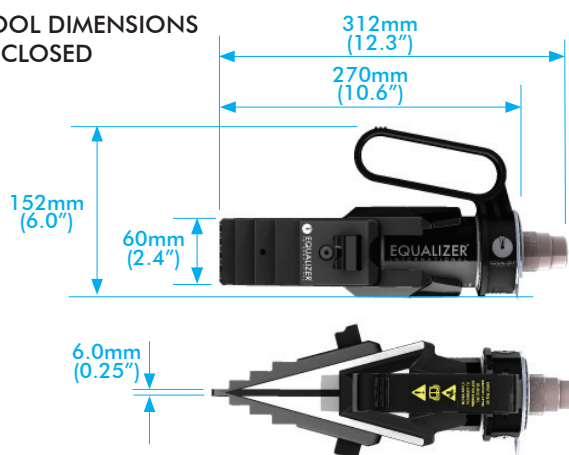

### USER FEATURES

- Practical, portable and lightweight
- Moulded plastic handle for comfort
- Revolving handle to aid horizontal or vertical spreading
- Offset handle is directly over the centre of mass
- Removable handle for improved access
- Revolving lanyard connection point
- Swivel hose coupler with elbow – improves access by allowing hose to revolve
- Spread indicator markings for clear precise visual progress feedback

### SAFETY FEATURES

- No finger pinch-points
- Increased step depth on upper steps
- Safety lanyard – 1.0m (39") length
- Partially recessed coupler reduces coupler vulnerability
- Forged key components for strength and reliability
- Fail-safe design – designated cylinder nose seal failure

### MAINTENANCE FEATURES

- Rapid disassembly and assembly
- Quick jaw replacement – remove 1 fastener
- Quick tip replacement – remove 2 fasteners
- Narrow jaw teeth – improved tool wear

info@equalizerinternational.com  
www.equalizerinternational.com

# SWi20/25TE

HYDRAULIC FLANGE SPREADER



FLANGE TOOL INNOVATION

## JAW DIMENSIONS (WITHOUT STEPPED BLOCKS ATTACHED)

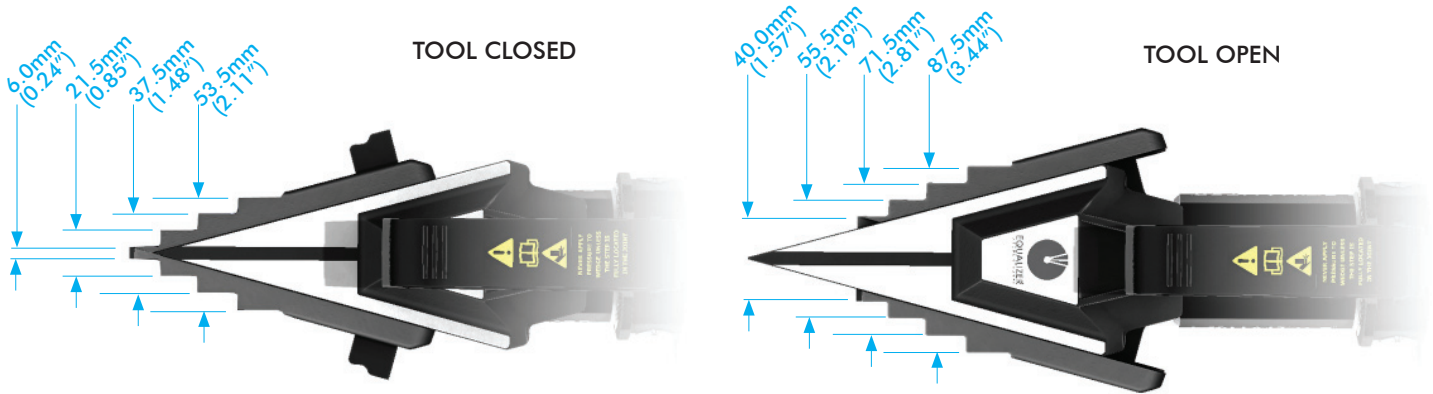

## JAW DIMENSIONS (WITH STEPPED BLOCKS ATTACHED)

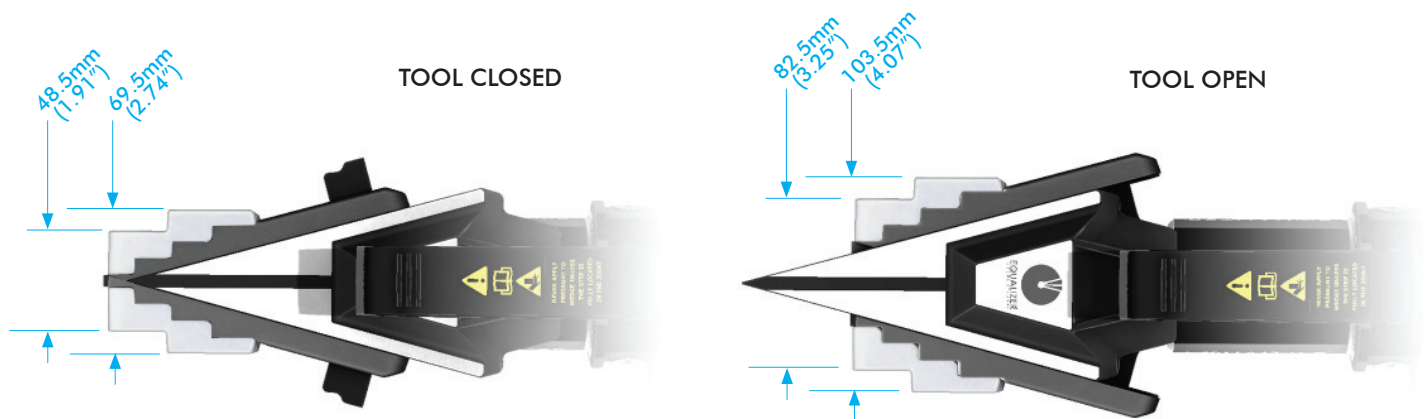

### MAXI KIT

2 x SWi20/25TE Flange Spreader Wedgeheads  
2 x 10,000psi (700bar) Hydraulic Cylinders  
2 x 10,000psi (700bar) Hydraulic Hoses, 2m (78.75") with 90 degree elbow  
1 x 10,000psi (700bar) HP550D Sealed Hand Pump with Gauges  
2 x Sets of Safety Blocks  
2 x Pairs of Stepped Blocks  
2 x Hex Keys  
2 x Lanyards  
1 x Instruction Manual  
1 x Plastic Carry Case

920mm x 500mm x 205mm (36.2" x 19.7" x 8.1")  
Gross Kit Weight 33.0kg (72.8lb)  
Product Code: SWi2025TEMAXSPB



### STANDARD KIT

1 x SWi20/25TE Flange Spreader Wedgehead  
1 x 10,000psi (700bar) Hydraulic Cylinder  
1 x 10,000psi (700bar) Hydraulic Hose, 2m (78.75") with 90 degree elbow  
1 x 10,000psi (700bar) HP350S Sealed Hand Pump with Gauge  
1 x Set of Safety Blocks  
1 x Pair of Stepped Blocks  
1 x Hex Key  
1 x Lanyard  
1 x Instruction Manual  
1 x Plastic Carry Case

920mm x 500mm x 205mm (36.2" x 19.7" x 8.1")  
Gross Kit Weight 20.7kg (45.7lb)  
Product Code: SWi2025TESTDSPB



### MINI KIT

1 x SWi20/25TE Flange Spreader Wedgehead  
1 x 10,000psi (700bar) Hydraulic Cylinder  
1 x Set of Safety Blocks  
1 x Pair of Stepped Blocks  
1 x Hex Key  
1 x Lanyard  
1 x Instruction Manual  
1 x Plastic Carry Case

580mm x 330mm x 165mm (22.8" x 13.0" x 6.5")  
Gross Kit Weight 11.6kg (25.6lb)  
Product Code: SWi2025TEMIN





"innovation in its most functional form"

## PRODUCT DATA SHEET

# SWi20/25TI

## INTEGRATED HYDRAULIC FLANGE SPREADER

### SPREADING FORCE:

20T (200kN) 1st step

25T (240kN) 4th step

### SPREADING DISTANCE:

6.0 - 103.5mm (0.24 - 4.0")

WEIGHT: 8.5kg (18.8lb)

### CAPABILITIES

At 10,000psi (700bar):

20T spread force (1st step)

24T spread force (4th step)

6.0mm – 87.5mm  
(0.24" - 3.4") spread over 4 steps  
(without stepped blocks)

48.5mm – 103.5mm  
(1.9" - 4.1") spread over 2 steps  
(with stepped blocks)

6.0mm – 40.0mm  
(0.24" - 1.6") spread  
using only 1st step



### TOOL DIMENSIONS - CLOSED

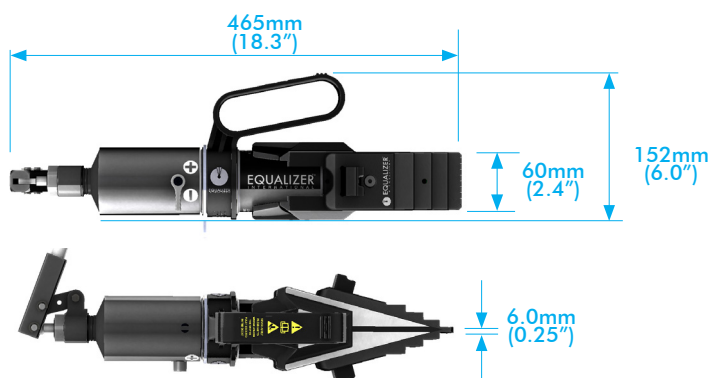

### USER FEATURES

- Practical, portable and lightweight
- Moulded plastic handle for comfort
- Revolving handle to aid horizontal or vertical spreading
- Offset handle is directly over the centre of mass
- Removable handle for improved access
- Revolving lanyard connection point
- Spread indicator markings for clear precise visual progress feedback

### SAFETY FEATURES

- No finger pinch-points
- Increased step depth on upper steps
- Safety lanyard – 1.0m (39") length
- Forged key components for strength and reliability
- Fail-safe design – designated cylinder nose seal failure

### MAINTENANCE FEATURES

- Rapid disassembly and assembly
- Quick jaw replacement – remove 1 fastener
- Quick tip replacement – remove 2 fasteners
- Narrow jaw teeth – improved tool wear

info@equalizerinternational.com  
www.equalizerinternational.com



# SWi20/25TI

INTEGRATED HYDRAULIC FLANGE SPREADER



"innovation in its most functional form"

## JAW DIMENSIONS (WITHOUT STEPPED BLOCKS ATTACHED)

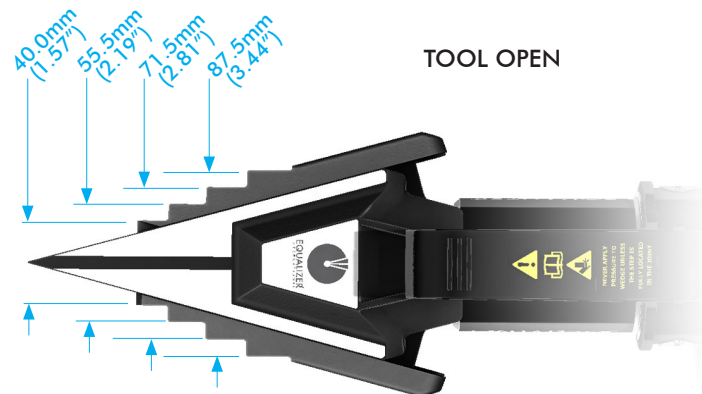
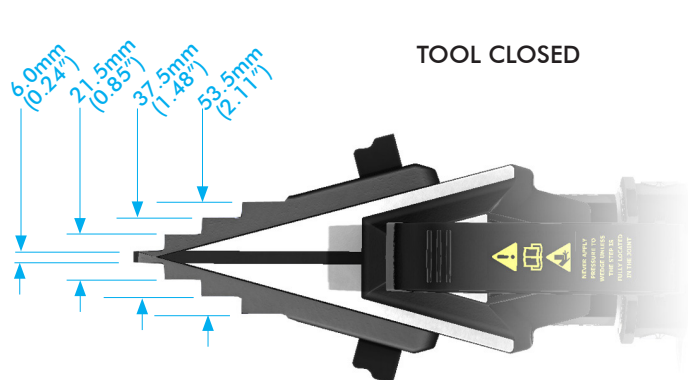

## JAW DIMENSIONS (WITH STEPPED BLOCKS ATTACHED)

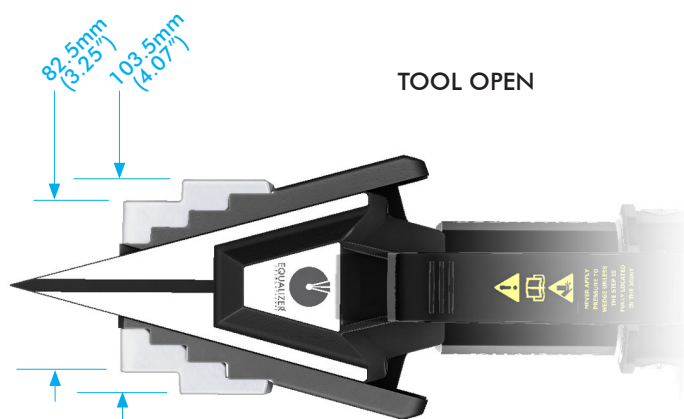
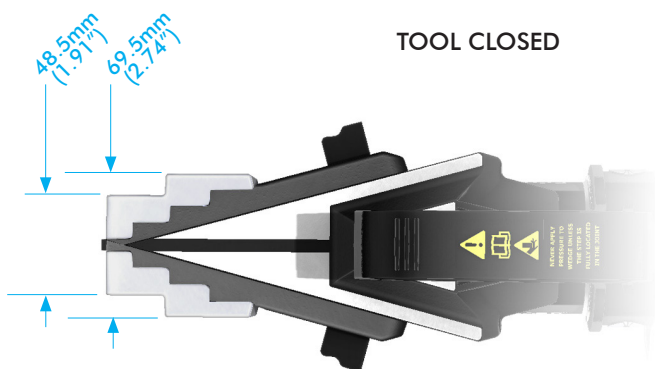

## STANDARD KIT

- 1 x SWi20/25TI Flange Spreader Wedgehead
- 1 x 10,000psi (700bar) Integral Hydraulic Pump/Cylinder
- 1 x Set of Safety Blocks
- 1 x Pair of Stepped Blocks
- 1 x Lanyard
- 1 x Hex Key
- 1 x Carry-Strap
- 1 x Instruction Manual
- 1 x Carry Case

580mm x 330mm x 165mm (22.8" x 13.0" x 6.5")  
Gross Kit Weight 13.8kg (30.3lb)  
Product Code: SWi20/25TISTDSPB

