

Max. Capacity: 4 Ton (PM400 & PME400), 6 Ton (PM600 & PME600)
8 Ton (PM800 & PME800), 12 Ton (PM1200 & PME1200)
20 Ton (PM2000 & PME2000), 30 Ton (PM3000 & PME3000)

Note: These instructions must be read and followed carefully.

SAFETY NOTES

- ◆ These pullers should be used by trained operators familiar with them.
- ◆ Select the proper size and capacity of the puller for dismantling jobs.
- ◆ Align the puller on the same centerline as the part being removed. Failure to align parts correctly can result in a dangerous operating situation because of the high hydraulic pressure used. Self-Centering models can be aligned on the centerline after the pullers fully engaged with the part.
- ◆ Wrap the work piece with the protective blanket before applying pressure to protect any possible injury caused by the broken parts.
- ◆ Always apply force gradually.
- ◆ Never heat the workpiece to be removed, when the puller connect with the part. The heat may result in the damage on the parts of puller.

SETUP AND OPERATION

NOTE: These pullers have 2/3-way combination puller heads; the 3-way combination is strongly recommended whenever the working space allows for it. Three jaws provide more secure gripping and even pulling force.

1. Select the proper size and capacity of puller suitable for the workpiece, which is determined by measuring “reach” and “spread” of the part to be pulled.
2. Screw the foldable handle into the handle clevis. See below.

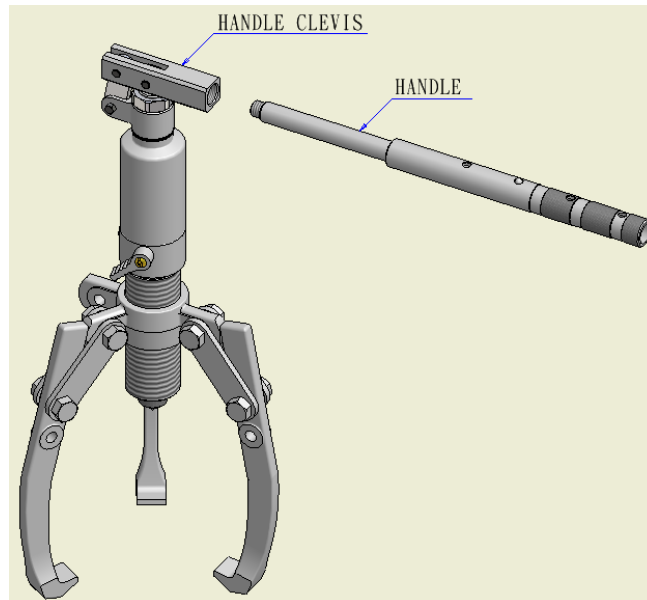

3. Turn the control valve knob completely in a clockwise direction to advance the piston.

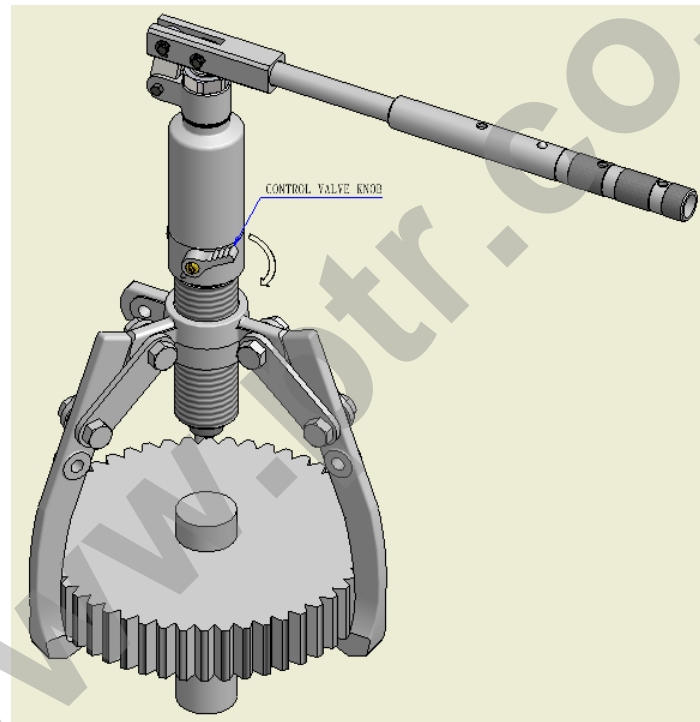

4. Puller Locating:

a). For PM models:

Place the puller and puller jaws around the workpiece to be pulled, removing most of the slack by threading the puller body forward or adjusting the puller straps on the jaws. Pump the handle to advance the piston until the removable cone touches the central of the workpiece. The puller must be at the same centerline as the workpiece to be pulled and the jaws fully engaged and secure.

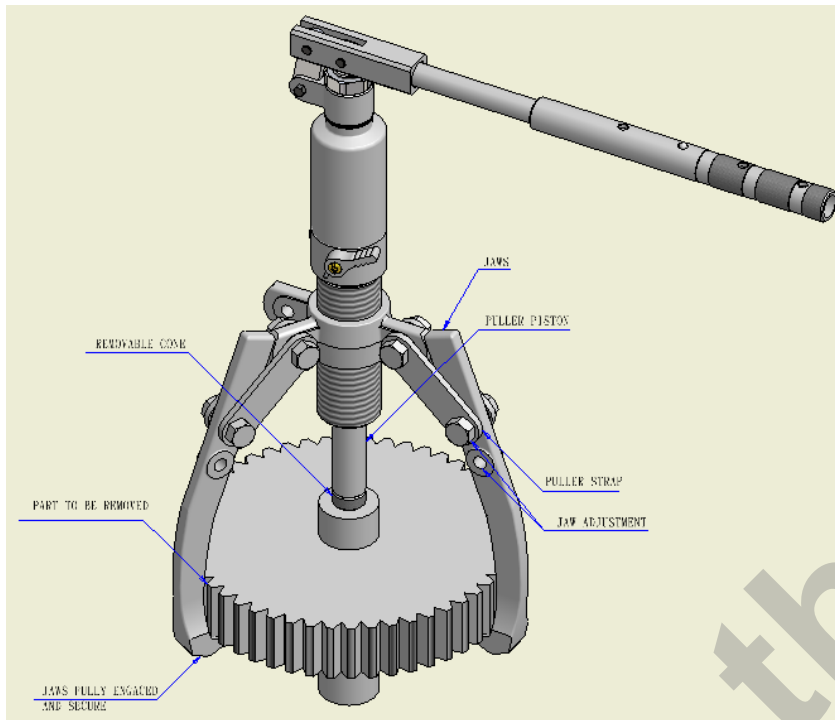

b). For PME models:

Place the puller and puller jaws around the workpiece to be pulled, removing most of the slack by threading the adjusting ring on puller body forward. Pump the handle to advance the piston until the removable cone touches the central of the workpiece. Make final puller positioning adjustments with the piston. In case the more “reach” needed, dismantle the removable cone from the piston rod and assemble the extra attached extension rod and removable cone on the piston rod as well. See below.

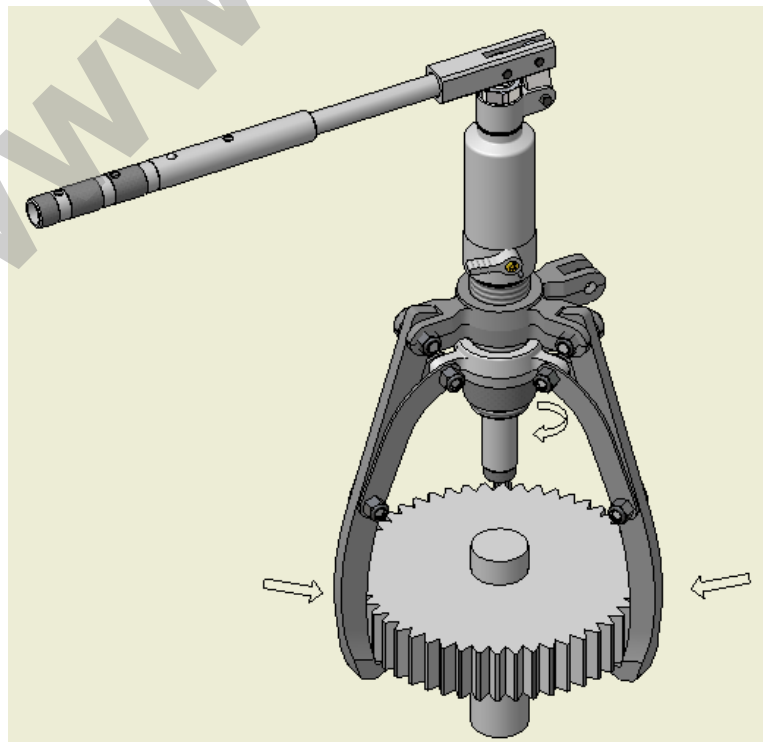

5. The handle rotates a full 360° to allow the best location for pumping as below.

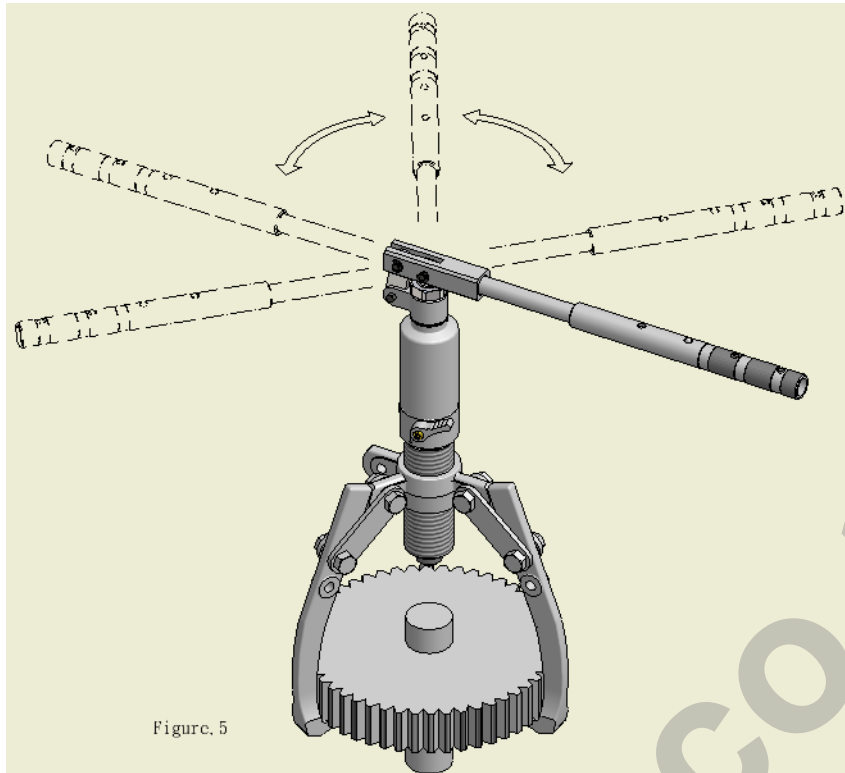

6. Hold the puller with one hand and pump the handle with the other hand, advancing the piston until the part is removed.

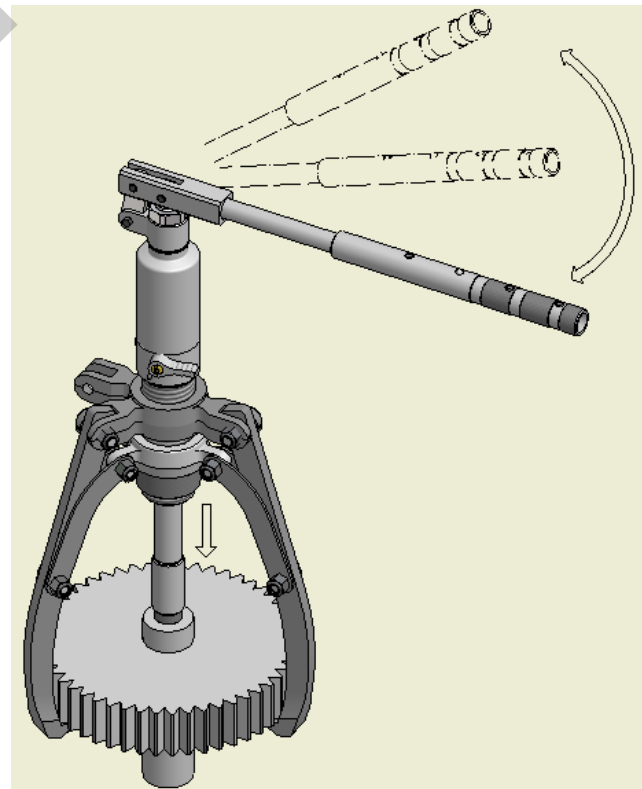
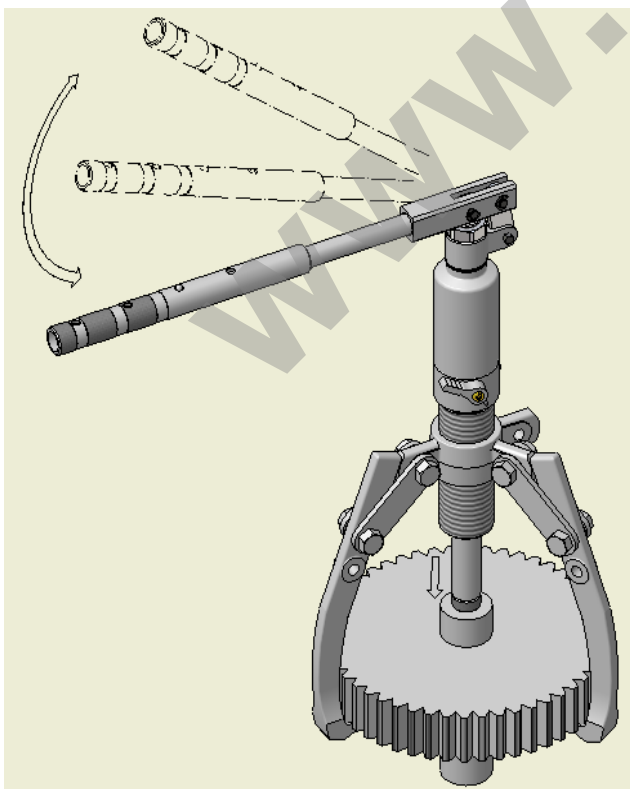

7. Turn the control valve knob completely in a counterclockwise direction to retract the piston.

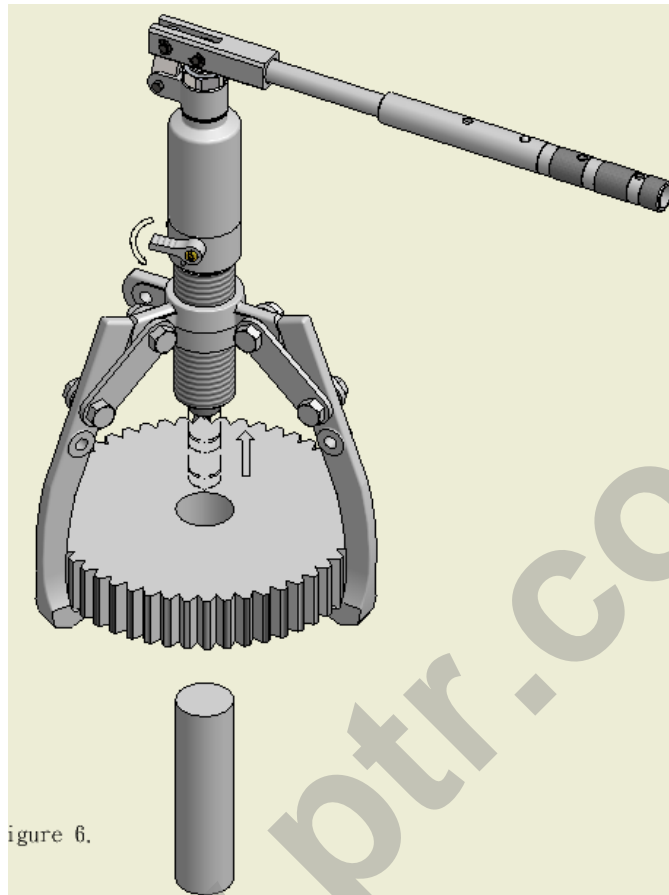

Figure 6.